

Scara de proiect: 1:500  
Calea Mureș Neagra 1975

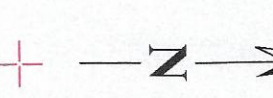

PROFIL TRANSVERSAL CARACTERISTIC al stazei Lucerna 1-1  
scara 1:100  
existenț propus

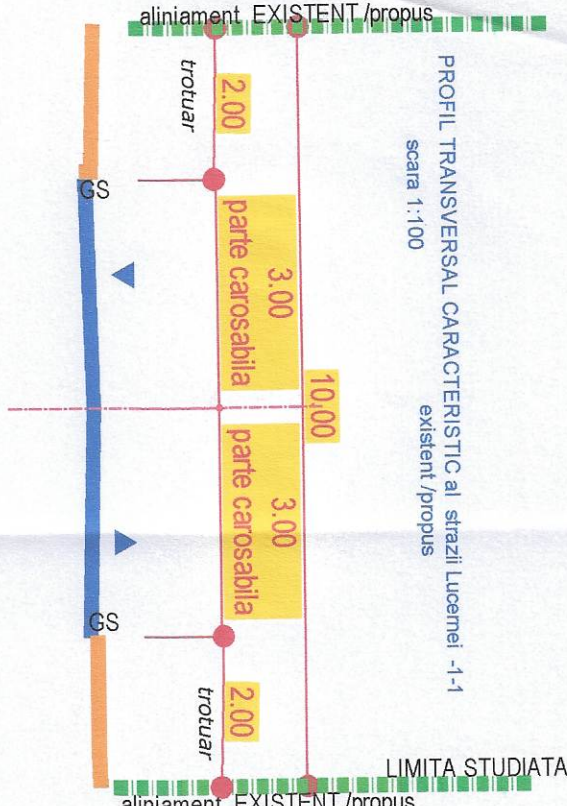

PROFIL TRANSVERSAL CARACTERISTIC al stazei Zăvoiu 3-3  
scara 1:100  
existenț propus

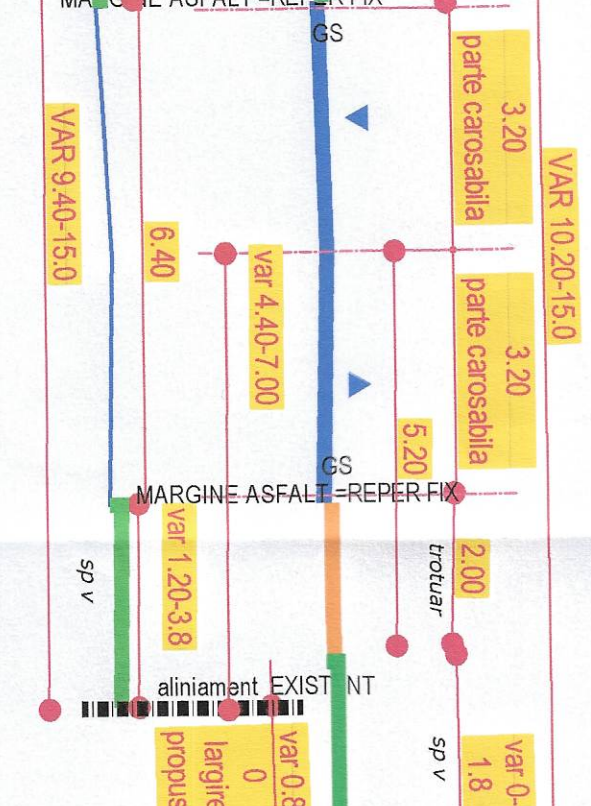

PROFIL TRANSVERSAL CARACTERISTIC al stazei Zăvoiu 4-4  
scara 1:100  
existenț propus

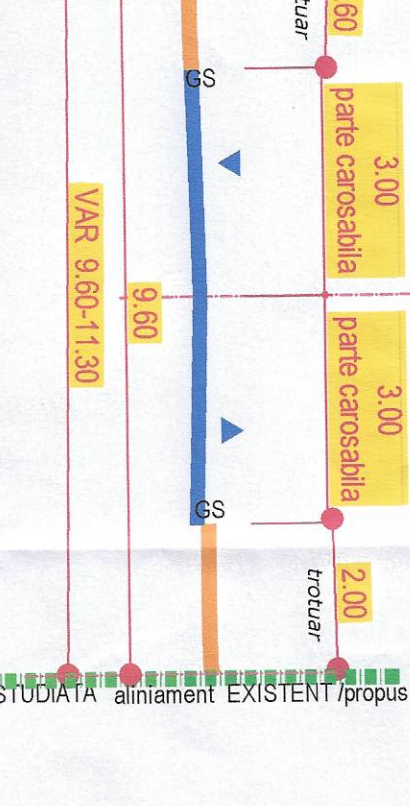

PROFIL TRANSVERSAL CARACTERISTIC al stazei Făgăuș 4-4  
scara 1:100  
existenț propus

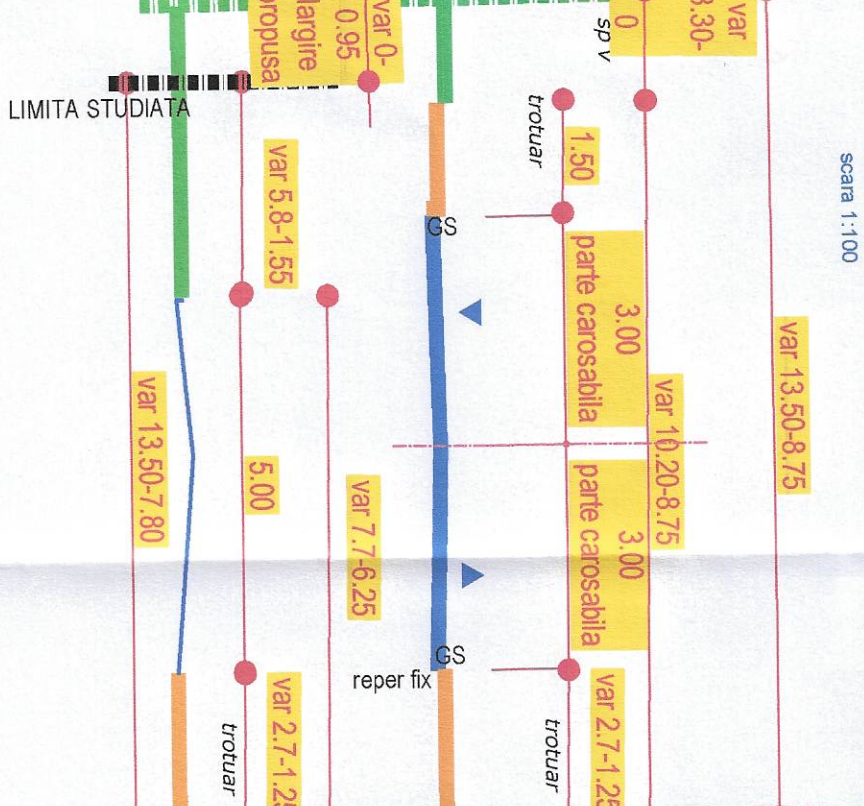

PROFIL TRANSVERSAL CARACTERISTIC al stazei A4-PROPIUS  
scara 1:100  
existenț propus



PROFIL TRANSVERSAL CARACTERISTIC al stazei C-C-PROPIUS  
scara 1:100  
existenț propus

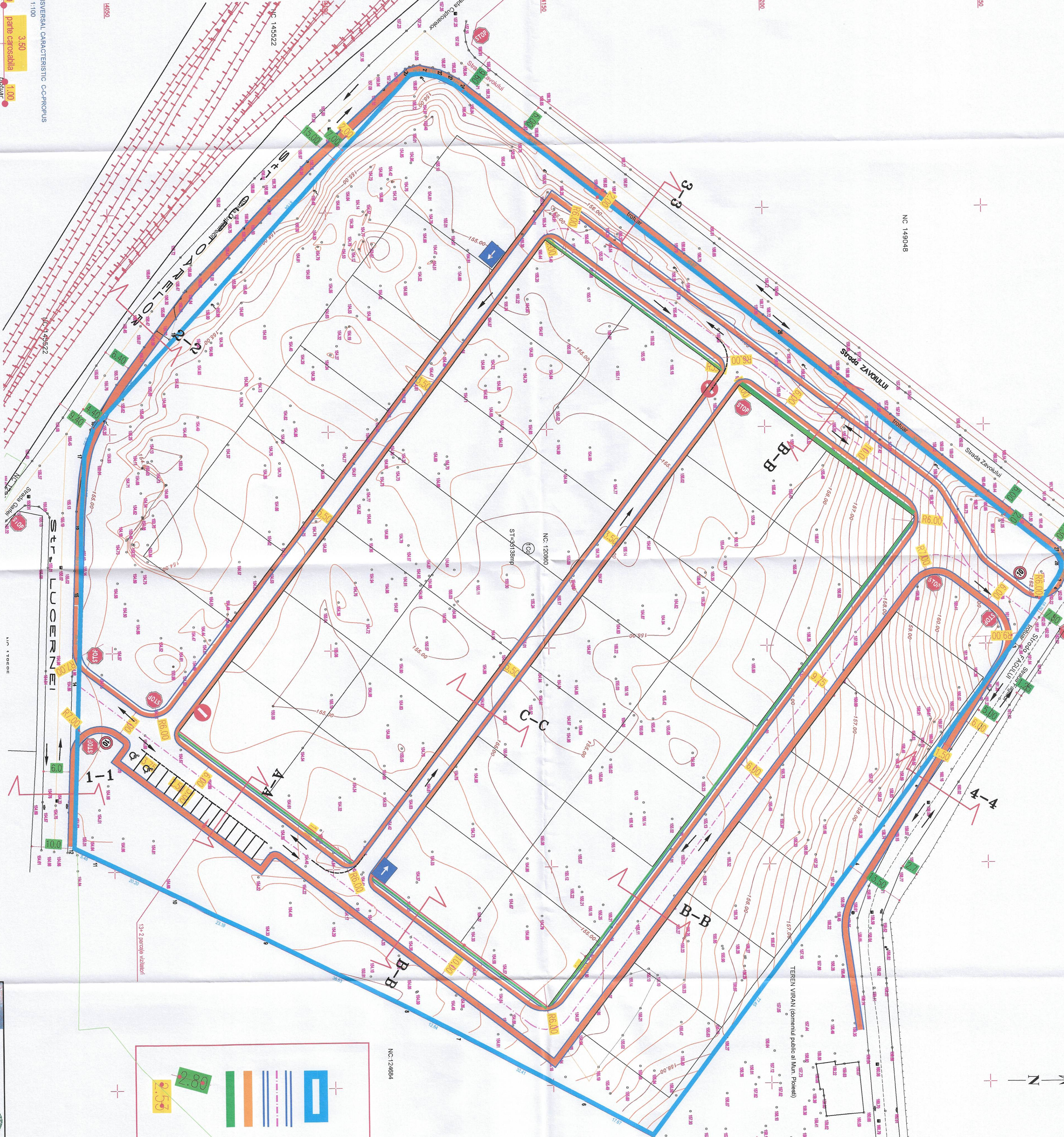
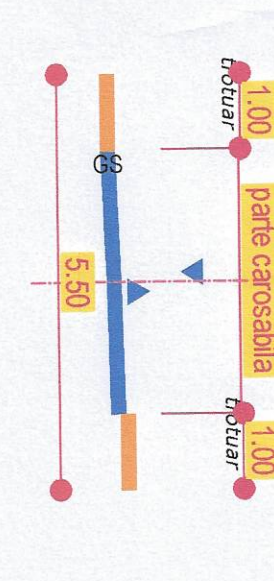

### LEGENDA

- Limita de proprietate ce a generat P.U.Z.
- Reproiectare dintr-un studiu
- Trotuar propus
- Spatiu verde propus
- Distanțe existente conform Ridicării Topografice
- Distanțe propuse

|  |                     |                                       |                     |             |
|--|---------------------|---------------------------------------|---------------------|-------------|
| SERVICIUL DE PROIECTARE URBANISTICĂ PLOIEȘTI |                     | PRIMĂRIA MUNICIPIULUI PLOIEȘTI        |                     | Proiect nr. |
| STRADA LUCERNA, NR. 18                       |                     | STRADA LUCERNA, NR. 18, Iud. Ploiești |                     | 161/2023    |
| Proiectat                                    | Ing. Edmon Sorin    | Desenat                               | Ing. Copanu Nicodan | Faza:       |
| Verificat                                    | Ing. Copanu Nicodan | Proiectat                             | Ing. Copanu Nicodan | P.U.Z.      |
| Verificat                                    | Ing. Copanu Nicodan | Proiectat                             | Ing. Copanu Nicodan | Plan D. 1   |
| 09.2023                                      |                     | FUNDAMENTAREA CIRCULAȚIEI             |                     |             |